

# Steering Pump

## Control Valve Inspection and Replacement (cont'd)

9. Clean all the parts in solvent, dry them off then reassemble and retest the flow control valve.

NOTE: If necessary, relief pressure is adjusted at the factory by adding shims under the check ball seat. If you found shims in your valve, be sure you reinstall as many as you took out.

10. Install the flow control valve in the reverse order of removal.

- Apply steering grease (Honda P/N 08733-B070E) to new O-ring.
- Coat the flow control valve with power steering fluid then install it and the spring.

NOTE: When replacing the flow control valve, be sure the replacement flow control valve has the same identification letter as the original flow control valve.

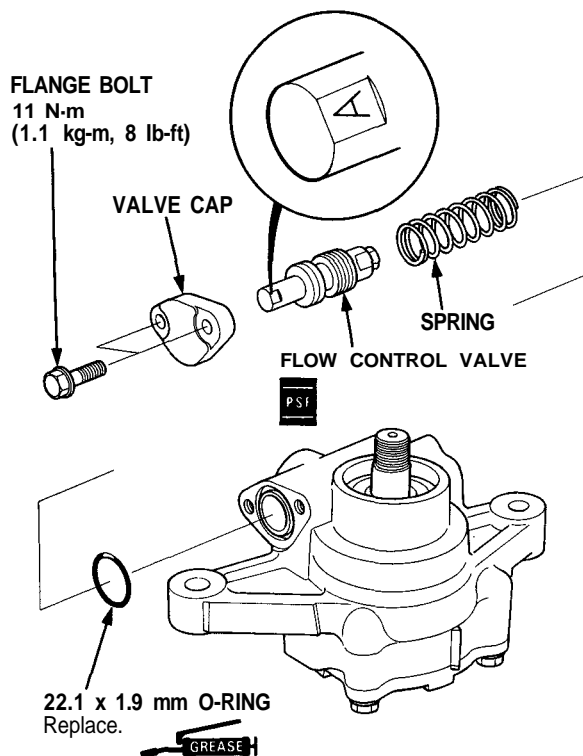

## Pump Disassembly

**CAUTION:** The pump components are made of aluminum. Be careful not to damage them when servicing.

1. Remove the pump from car (see page 17-31).
2. Remove the pulley (see page 17-32).
3. Remove the flow control valve (see page 17-32).
4. Remove the inlet joint and 13.3 x 1.9 mm O-ring.

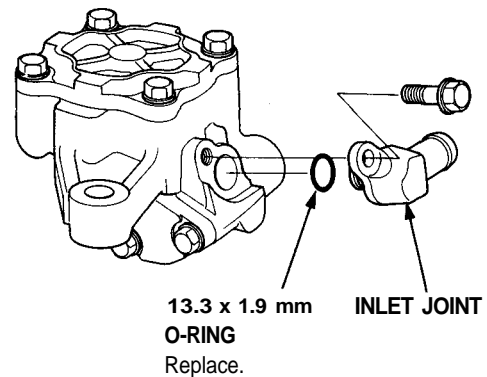

5. Remove the pump cover.

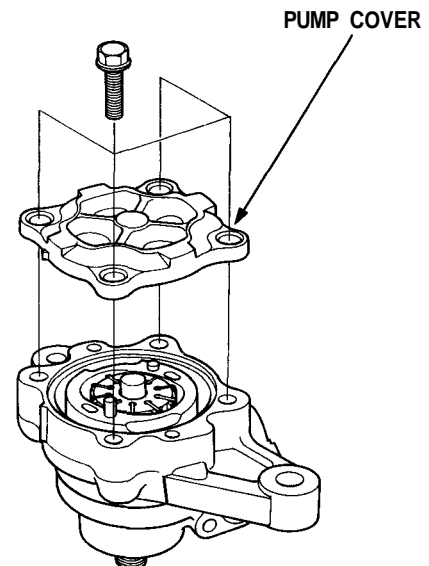



6. Remove the pump cam ring from the pump housing.

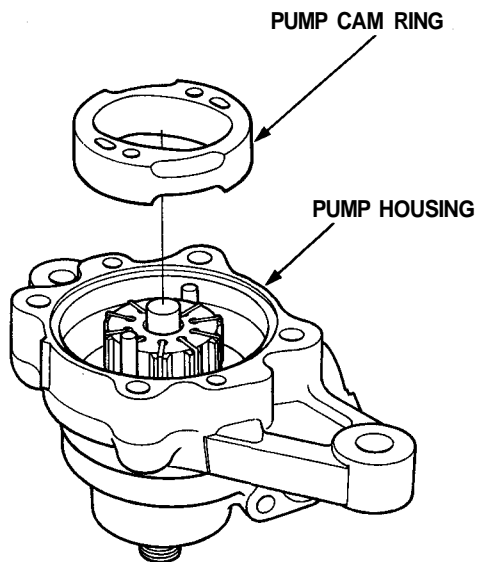

7. Remove the pump rotor and pump vanes.

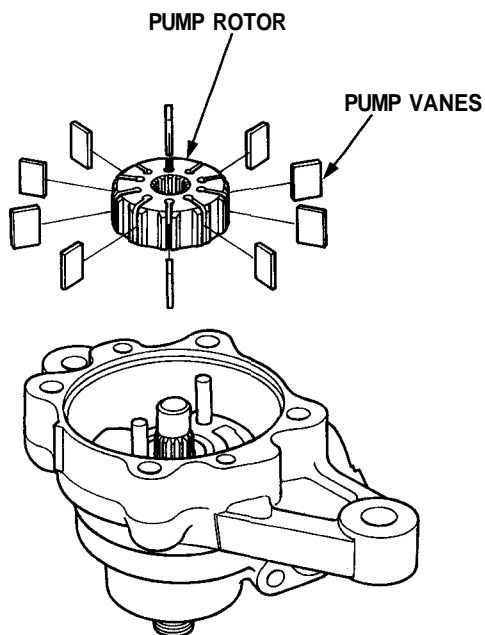

8. Remove the two rollers from the side plate.

9. Remove the side plate and preload spring.

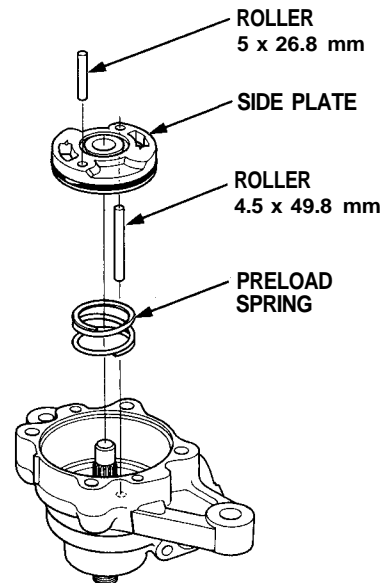

10. Remove the circlip, then remove the drive shaft from the pump housing using a plastic hammer.

11. Remove the pump seal spacer and oil seal.

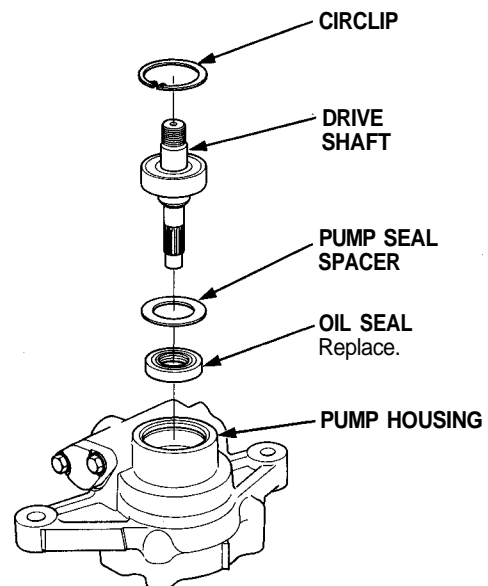

(cont'd)

# Steering Pump

## Pump Disassembly (cont'd)

12. Inspect the bearing by rotating the outer race slowly. If any play or roughness is felt, it must be replaced. Perform step 13 and 14.

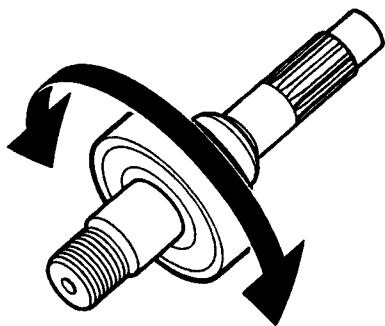

13. Remove the bearing using the special tool and press.

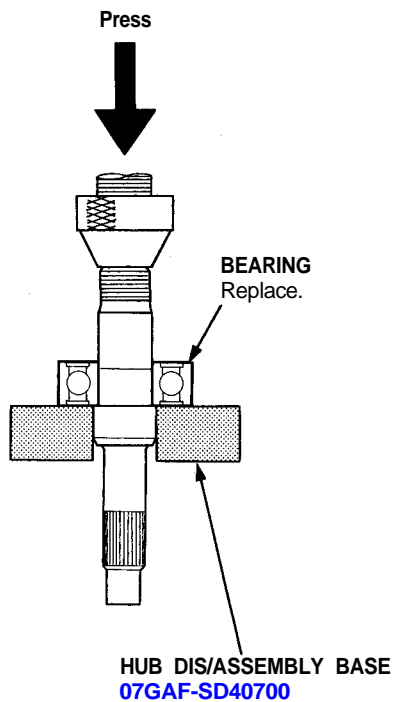

14. Install the new bearing using the press and special tool.

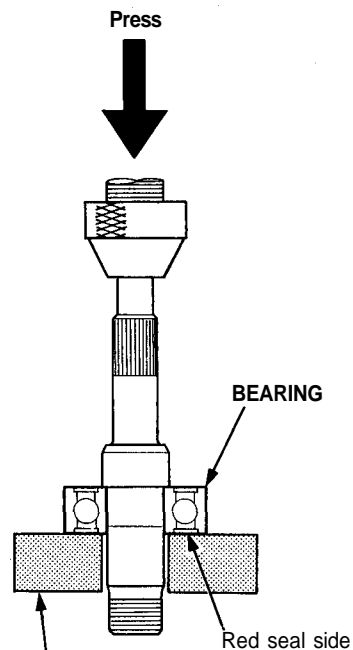

**HUB DIS/ASSEMBLY BASE**

**07GAF-SD40700**

NOTE: Hold the inner race with the tool securely.